

Quick Start Guide 快速操作指南

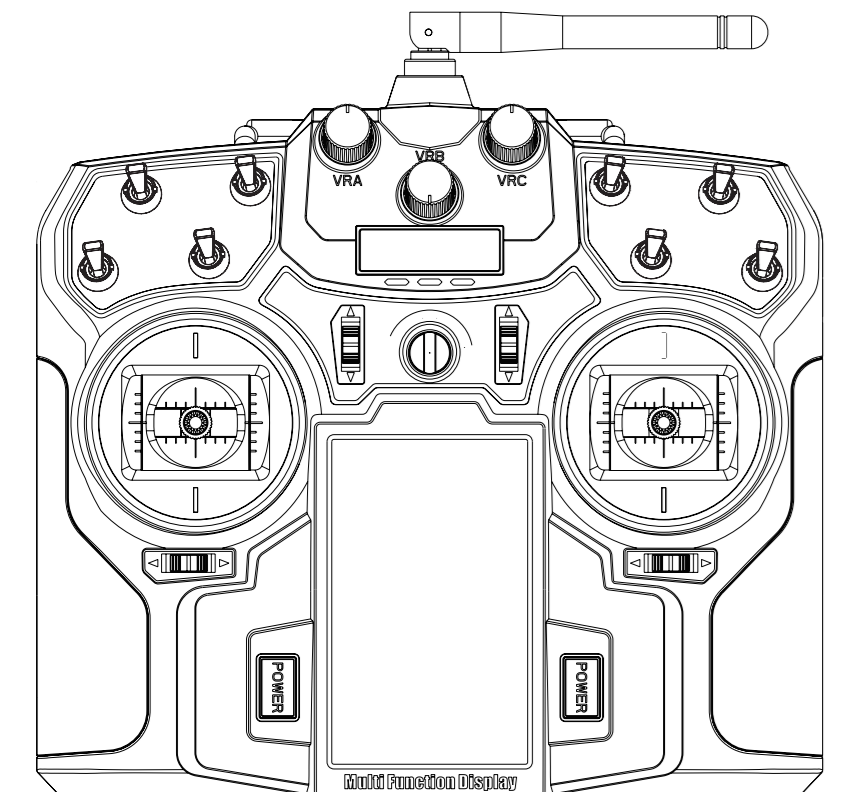

感谢您购买我们公司的产品！欲知更多产品信息，请浏览以下官方网站：www.flysky-cn.com。如果您在使用过程中遇到任何问题，请先查阅发射机帮助菜单或使用说明书。如果问题仍未得到解决，请直接联系当地经销商或者联系客服人员：flyskycn@flysky-cn.net

注意事项

开始操作前请务必仔细阅读以下安全信息！

- 请不要在夜晚或雷雨天气使用本产品，恶劣的天气环境有可能导致遥控设备失灵。
- 请不要在能见度有限的情况下使用本产品。
- 请不要在雨雪或有水的地方使用本产品，如果有液体进入到系统内部，可能会导致运行不稳定或设备失灵。
- 信号干扰可能导致设备失控。为保证您和他人的安全，请不要在以下地点使用本产品：



- 当您感到疲倦、不舒服，或在摄入酒精或导致麻醉或兴奋的药物后，不要操作本产品，否则可能对自己或他人造成严重的伤害。
- 2.4GHz 无线电波段完全不同于之前所使用的低频无线电波段。使用时请确保模型产品在您的视线范围内飞行，大的障碍物将会阻断无线电频率信号从而导致失控失灵。
- 在使用过程中，严禁紧握手发射机天线，否则将会大大减弱无线电传播信号的质量和强度，导致遥控失灵模型失控。
- 在操作或使用模型后，请勿触摸任何可能发热的部位，如发动机、电机、定速设定等。这些部件可能非常热，容易造成严重的烧伤。
- 遥控设备使用不当可能导致操作者或他人严重受伤，甚至死亡。为保证您和设备的安全，请仔细阅读使用说明书并按照要求进行操作。
- 使用前必须确保本产品与模型安装正确，否则可能导致模型发生严重损坏。
- 关闭时，请务必先关闭接收机电源，然后关闭发射机。如果关闭发射机电源时接收机仍然在工作，将有可能导致遥控设备失控或者引擎继续工作而引发事故。
- 操控时，请先确认模型所有舵机的动作方向与操控方向一致。如果不一致，请调整好正确的方向。
- 当遥控距离持续较远时，有发生失控的可能。请适当缩短遥控的距离。
- 特此，【Flysky Technology co.,ltd】声明无线电设备【FS-18】符合 RED2014/53/EU。
- 欧盟 DoC 声明、FCC 声明可在以下互联网地址：www.flysky-cn.com 获取。
- The antenna(s) used for this transmitter must be installed to provide a separation distance of at least 20 cm from all persons and must not be co-located or operating in conjunction with any other transmitter. End-users and installers must be provided with antenna installation instructions and transmitter operating conditions for satisfying RF exposure compliance.
- CAUTION
RISK OF EXPLOSION IF BATTERY IS REPLACED BY AN INCORRECT TYPE. DISPOSE OF USED BATTERIES ACCORDING TO THE INSTRUCTIONS.

发射机概览

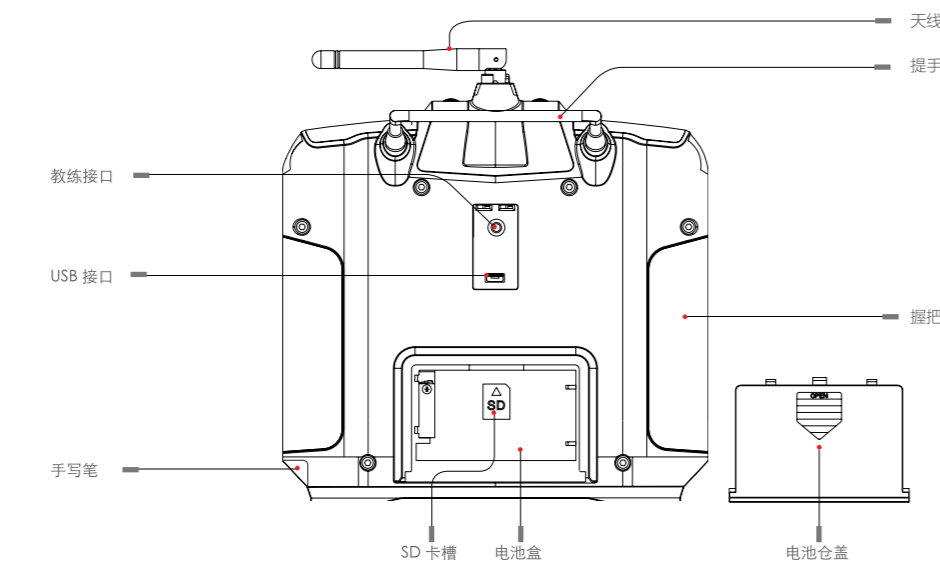
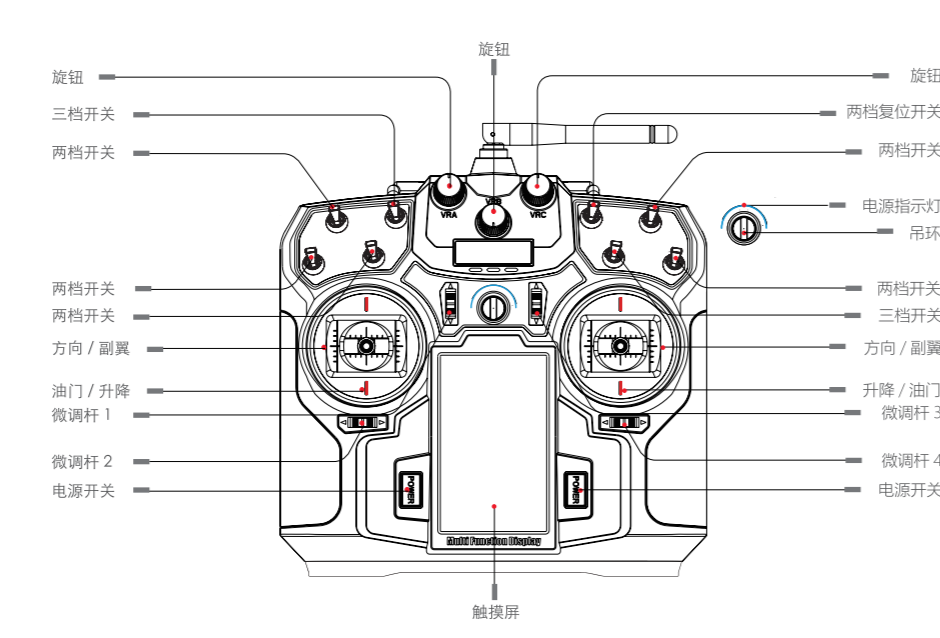

更多发射机操作请参照说明书 (2017/09 版) 进行操作。

屏幕按键介绍

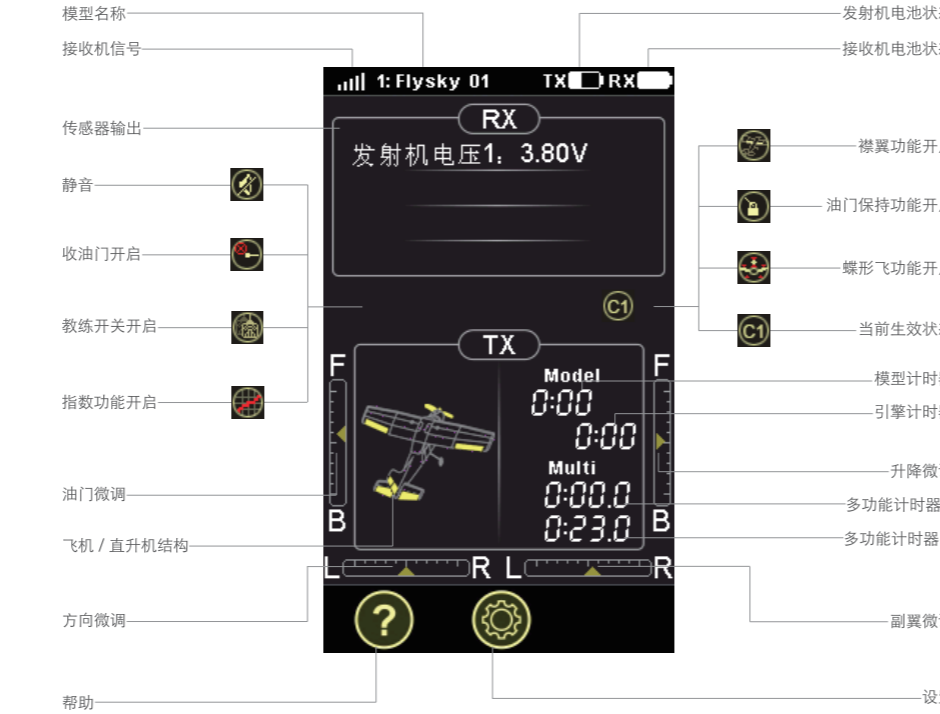

功能菜单中会出现一些通用的图标，均位于显示屏的下方。

- 返回图标：按下该图标后返回上一级菜单或退出当前菜单。
- 复位图标：按下该图标后，当前功能项所有设置恢复为出厂默认设置。
- 开关分配图标：按下该图标后可以将一些功能分配到设备上的 SWA ~ SWH 开关、VRA ~ VRC 旋钮，方便对该功能进行操作。
- 激活图标：按下该图标后可以激活或关闭当前功能。显示绿色图标时，表示当前功能已激活，按下后会关闭该功能。显示红色图标时，表示当前功能已关闭，按下后可激活该功能。

基本操作

电池安装

- 打开电池仓盖。
- 将电池装入电池仓内，确保电池仓内的金属端子接触良好。
- 改好电池仓盖。

开机

- 确保所有开关都处于最上端位置，油门摇杆处于最低端位置。
- 同时按下两个电源开关，状态指示灯点亮时，表示已开机。
- 为接收机连接电源。

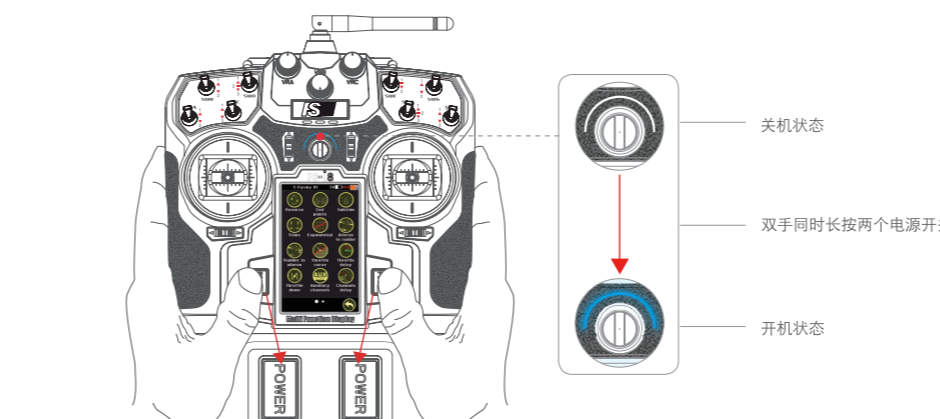

如果有开关未拨到最高档位或油门摇杆没有打到最低位置，系统会弹出“为了安全，把所有开关拨到上面，油门打到最低”的提示，按照要求检查并将开关或摇杆调整到正确位置后方可正常开启发射机。

对码

本发射机和接收机在出厂前已对码成功。如果需要使用其他的发射机或接收机，请按照以下步骤进行对码：

- 在发射机上选择【设置】图标，从右向左滑动屏幕浏览设置菜单，然后选择【接收机设置】。

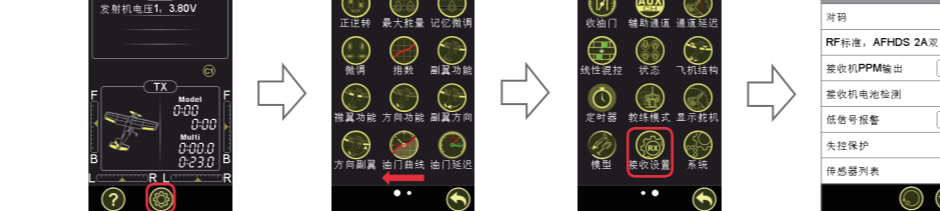

模型设置

模型为固定翼或滑翔机：

- 选择主界面的飞机结构图。
- 然后在飞机结构界面中，选择【修改.....】。
- 选择模型支持的结构。选择后，对应项右侧方框中显示蓝色对勾。
- 选择返回图标退出菜单。

RF 标准	接收机型号
AFHDS	GR3F、GR3E、R6B、R9B
AFHDS 2	iR4、iR4B、iR6B、iR10
AFHDS 2A 单向	A3、A6
AFHDS 2A 双向	iA4B、iA6、iA6B、iA10、iA10B、X6

注意：以上列表内容可能会由于产品更新有所不同。请以接收机上标示的 RF 标准为准。



模型为直升机：

- 选择【设置】图标，从右向左滑动屏幕浏览设置菜单，然后选择【模型】。
- 选择【设置模型类型】，然后选择【直升机】。在确认框中选择【是】进行确认。系统进入直升机结构菜单，菜单显示直升机相关配置项。
- 选择模型支持的结构，然后选择【返回】图标推出菜单。



对码

将对码线和电源从接收机上断开，然后重新将电源线连接到 B/VCC 接口，注意电源接口正负极必须正确。

- 检查发射机能否正常工作，如重复对码，请重复以上步骤。

规格参数

通道个数	8
适合机种	固定翼、滑翔机、直升机
频率范围	2.408-2.475 GHz
波段宽度	500KHz
波段个数	135
发射功率	< 20dBm
接收灵敏度	-95dBm
2.4G 模式	AFHDS 2A / AFHDS
调制方式	CFSK
传输方式	FHSS
通道分辨率	4096
通道延时	< 15ms
低电压报警	< 3.7V
数据输出	Micro-USB
充电接口	Micro-USB
天线类型	26mm
输入电源	3.7V
显示方式	WQGA 3.55 寸 TFT 彩屏 262K 240*400 点阵 LCD 白色背光电阻式触摸屏
在线更新	Micro-USB 接口更新
空旷无干扰地面距离 (发射接收地面 1 米)	> 300m
额定功率	< 1W
各通道数据	中位: 1500us; 范围: 1000 ~ 2000us
外形尺寸	190*95*255mm
外壳颜色	黑色
机身重量	720g
安规认证	CE, FCC

关机

- 断开接收机电源。接收机连接电源的情况下系统无法关机。
- 同时按下发射机的两个电源按键，状态指示灯熄灭后表示发射机电源关闭。

关闭时，请务必先断开接收机电源，然后关闭发射机。如果关闭发射机电源时接收机仍然在工作，系统会弹出“为了安全，请先关闭接收机。”的提示。如果此时强行关闭发射机，将有可能导致遥控设备失控或者引擎继续工作而引发事故。



Digital Proportional Radio Control System



Http://www.flysky-cn.com
Copyright © 2017 Flysky Technology co., Ltd
Release date: 2017-11-24



Thank you for purchasing our product! To find out more about our products, visit our website at www.flysky-cn.com. If you encounter any problems during use, refer to the transmitter's on-board help files or instruction manual first. If the problem persists, contact your local dealer or contact us by email at: flyskycn@flysky-cn.net

Precautions

Read the safety messages listed below before operation!

- Do not use the product at night or during bad weather conditions, like rain or thunderstorms. It can cause erratic operation or loss of control.
- Do not use the product when visibility is limited.
- Do not expose the product to rain or snow. Any exposure to moisture (water or snow) may cause erratic operation or loss of control.
- Interference may cause loss of control. To ensure the safety of you and others, do not operate in the following places:

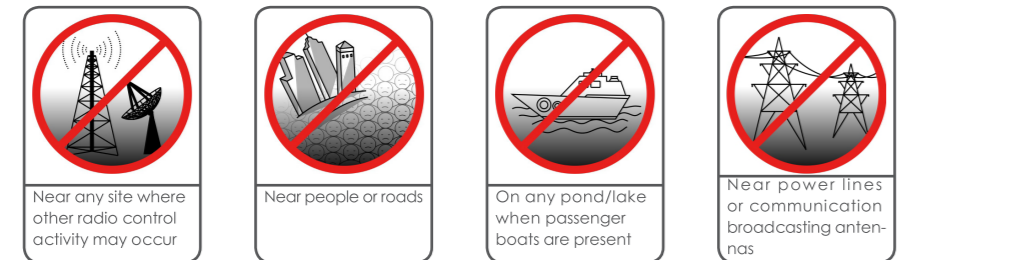

- Do not use this product when you are tired, uncomfortable, or under the influence of alcohol or drugs. Doing so may cause serious injury to yourself or others.
- The 2.4GHz radio band is limited to line of sight. Always keep your model in sight as a large can block the RF signal and lead to loss of control.
- Never grip the transmitter antenna during operation. It significantly degrades signal quality and strength and may cause loss of control.
- Do not touch any part of the model that may generate heat during operation, or immediately after use. The engine, motor or speed control, may be very hot and can cause serious burns.
- Misuse of this product may lead to serious injury or death. To ensure the safety of you and your equipment, read this manual and follow the instructions carefully.
- Make sure the product is properly installed in your model. Failure to do so may result in serious injury.
- Make sure that the receiver's battery is disconnected before turning off the transmitter. Failure to do so may lead to unintended operation and cause an accident.
- Ensure that all motors operate in the correct direction. If not, adjust the direction first.
- Make sure that the model stays within range in order to prevent loss of control.
- The antenna(s) used for this transmitter must be installed to provide a separation distance of at least 20 cm from all persons and must not be co-located or operating in conjunction with any other transmitter. End-users and installers must be provided with antenna installation instructions and transmitter operating conditions for satisfying RF exposure compliance.
- Hereby, [Flysky Technology co., Ltd] declares that the Radio Equipment [FS-i8] is in compliance with RED 2014/53/EU.
- The full text of the EU DoC and Appendix 1 of the FCC Statement are available at the following internet address: www.flysky-cn.com
- CAUTION**
RISK OF EXPLOSION IF BATTERY IS REPLACED BY AN INCORRECT TYPE. DISPOSE OF USED BATTERIES ACCORDING TO THE INSTRUCTIONS.

Transmitter Overview

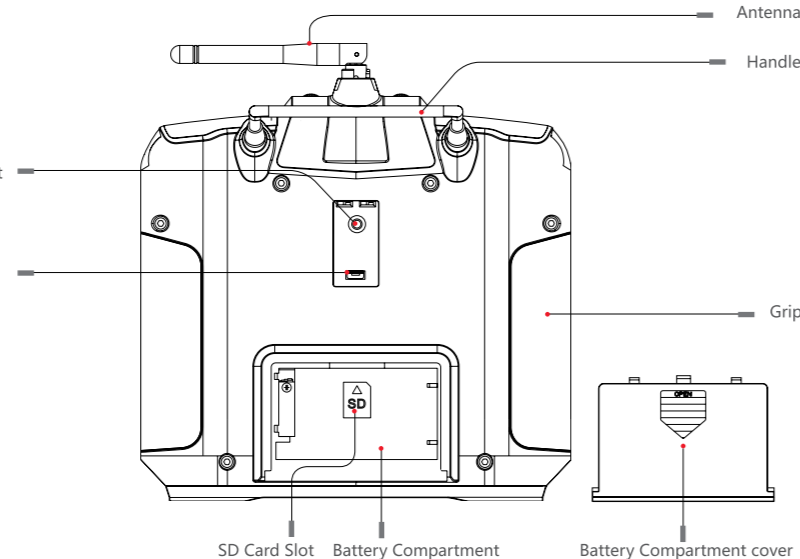
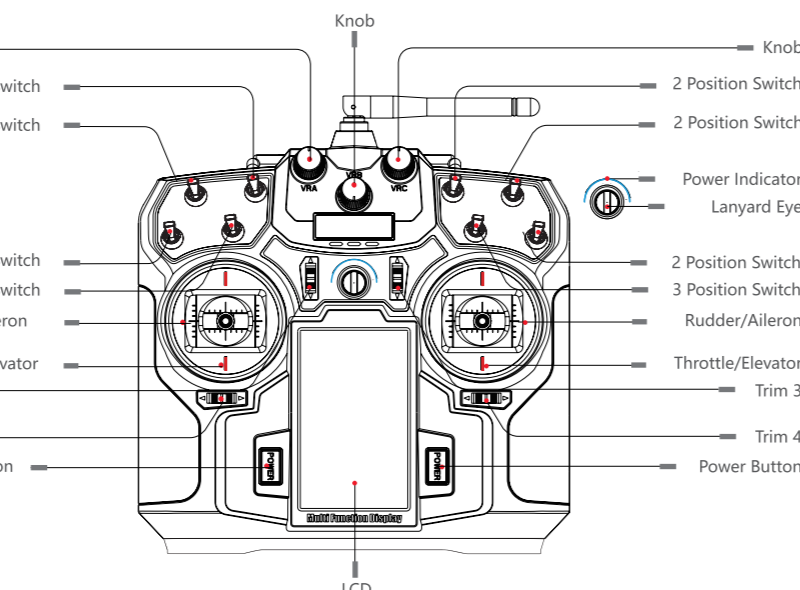

For more information on transmitter please refer to the products user manual (2017/09).

Screen Overview

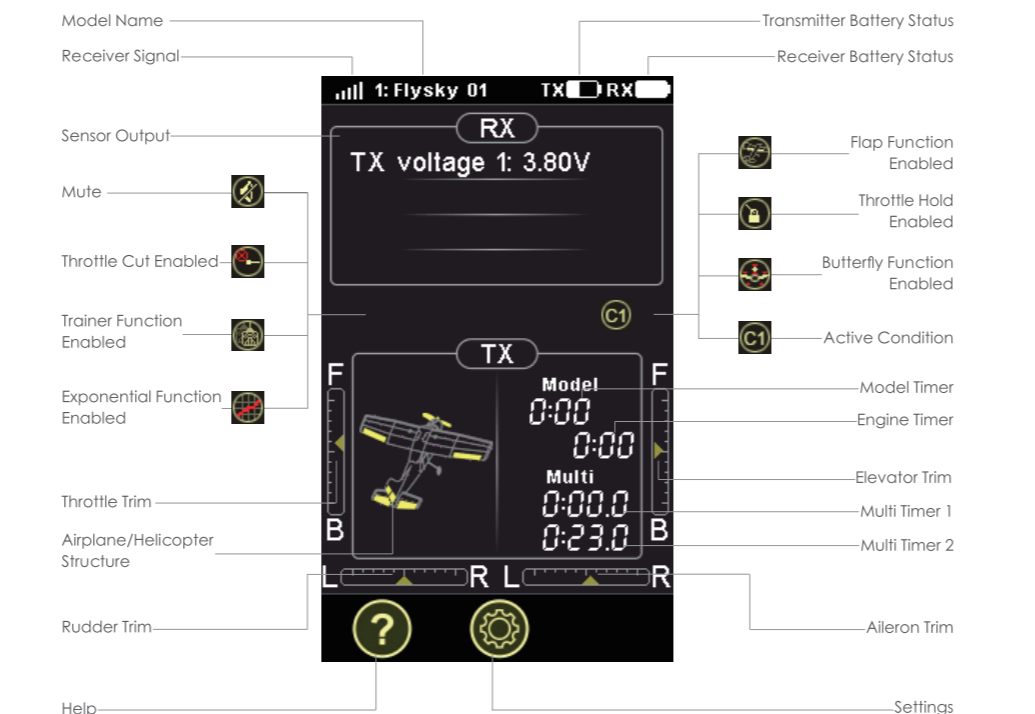

These are located on the bar at the bottom of the LCD.

- Back button: Use this icon to return to a previous menu or exit a function.
- Default button: This icon resets the current page to its default parameters.
- Assign Switch: Some functions require, or are assignable to a hardware switch (SWA ~ SWH) or knob (VRA ~ VRC).
- Enable/Disable: These icons enable and disable the current function. When the tick icon is visible the function is active.

Basic Operations

- #### Install the Battery
- Remove the battery compartment cover.
 - Insert the battery making sure the contacts on the battery, and in the system are properly aligned.
 - Replace the battery compartment cover.

- #### Power on
- Make sure that all switches are at their highest position and throttle is at its lowest position.
 - Hold down the two power buttons on each side of the screen until the status indicator lights up.
 - Connect the receiver power supply.

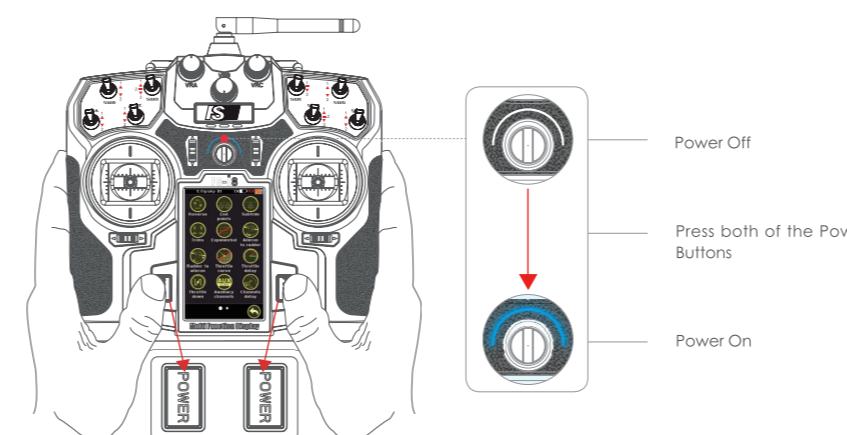

If the switches and throttle are not in their correct positions, the system will display a warning message.

Bind with Receiver

The transmitter and receiver have been pre-bound before delivery. If you are using another transmitter or receiver, follow the steps below to bind the transmitter and receiver:

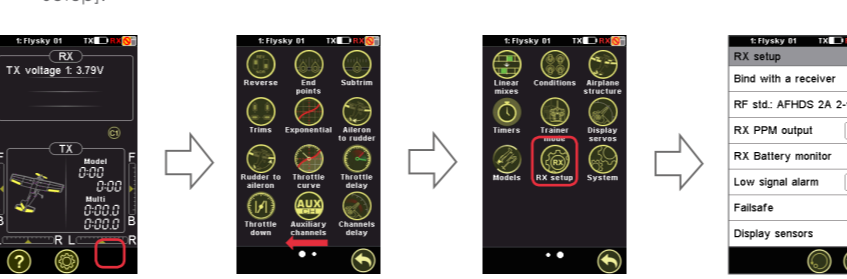

Bind with Receiver

The transmitter and receiver have been pre-bound before delivery. If you are using another transmitter or receiver, follow the steps below to bind the transmitter and receiver:

- Turn the transmitter on, press [Setup], swipe from right to left on the screen and then select [RX Setup].

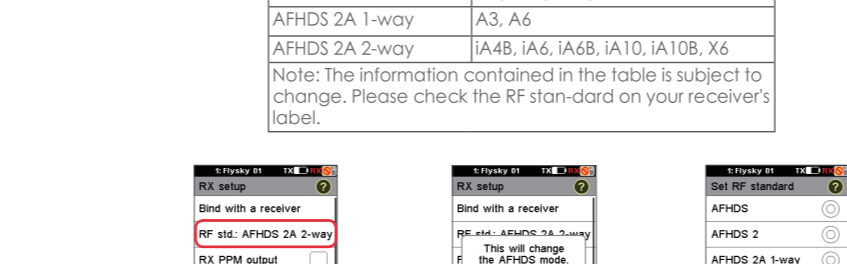

- Remove the bind cable from the receiver and disconnect the power cable. Then connect the power cable to the B/VCC port with the correct polarity.
- Check if all the servos work as expected. If anything does not work as expected, restart this procedure from the beginning.

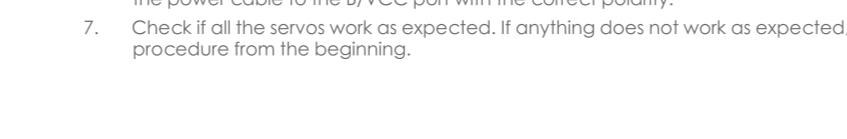
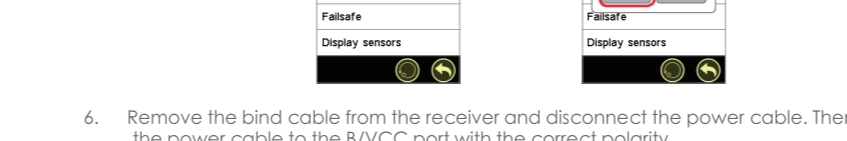
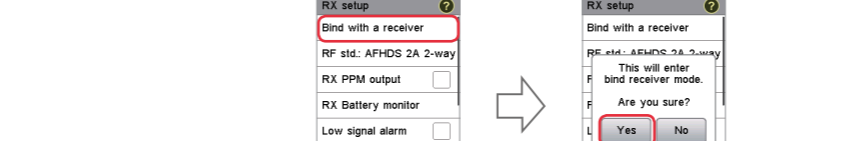
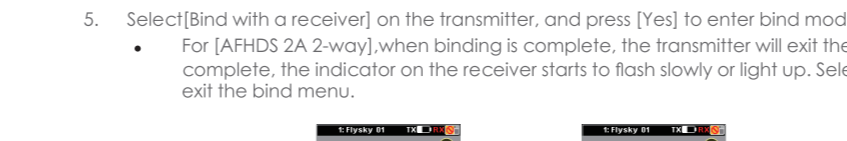
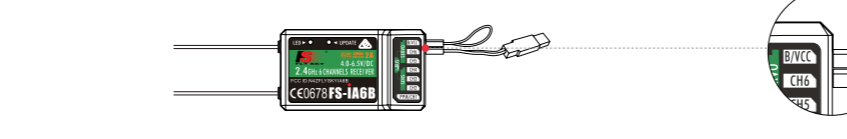

Model Setup

If you are flying an airplane or or glider:

- Touch the plane picture on the main screen and then select [Modify...] in the [Airplane structure] screen.
- Select the control surfaces that your model has.
- Select [Back] to exit the menu.

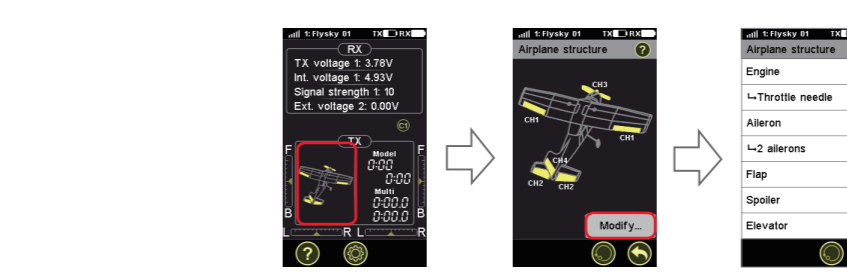

If you are flying a helicopter:

- Select [Setup], swipe left to right on the screen and then select [Models].
- Select [Set model type], and then [Helicopter]. Select [Yes] to confirm. Then the [Helicopter structure] screen displays.
- Select the configurations that your model has and then select [Back] to exit the menu.

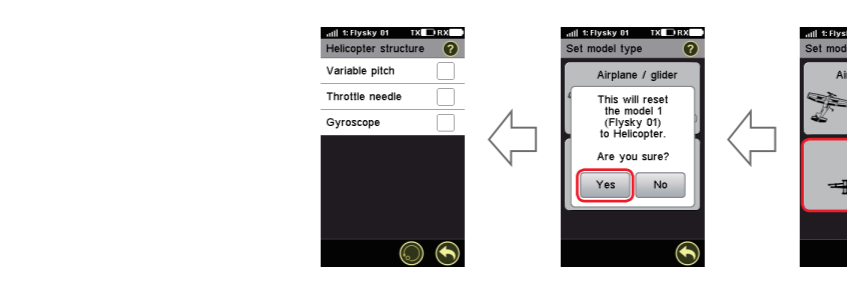
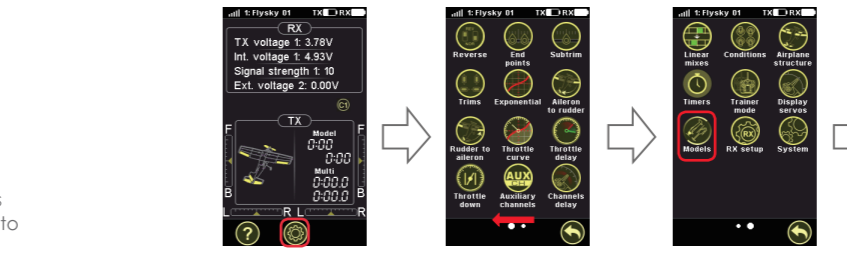

Power Off

- Disconnect the receiver from power. The system will not power off if the receiver is still connected.
- Hold down the power buttons on each side of the screen.

Make sure to disconnect the receiver's power before turning off the transmitter. If the receiver is still on, the system will prompt "For your safety, please turn off the receiver first.". If you turn off the transmitter forcefully, it may lead to unintended operation and cause an accident.



Specifications

Number of Channels	8
Model Type	Fixed-Wing/Glider/Helicopter
Frequency Range	2.408-2.475 GHz
Bandwidth	500KHz
Bands	135
Transmission Power	< 20dBm
Receiving Sensitivity	-95dBm
2.4GHz Protocol	AFHDS 2A / AFHDS
Modulation Mode	GFSK
Transfer method	FHSS
Channel Resolution	4096
Channel delay	< 15ms
Low Voltage Alarm	< 3.7V
Data Output	Micro-USB
Antenna Type	26mm
Input Power	3.7V
Display	WQGA 3.55 inch TFT color screen 240 * 400 dot, white backlight, resistive touch screen
Update Method	Micro-USB
Open ground without interference	> 300m
Rated power	> 1W
Channel Data Parameters	Median: 1500 us; Range: 1000 ~ 2000 us
Dimensions	190*95*255mm
Color	Black
Weight	720g
Safety Certification	CE, FCC